

# 51 SERIES

DIS. COD. 51.9557.00

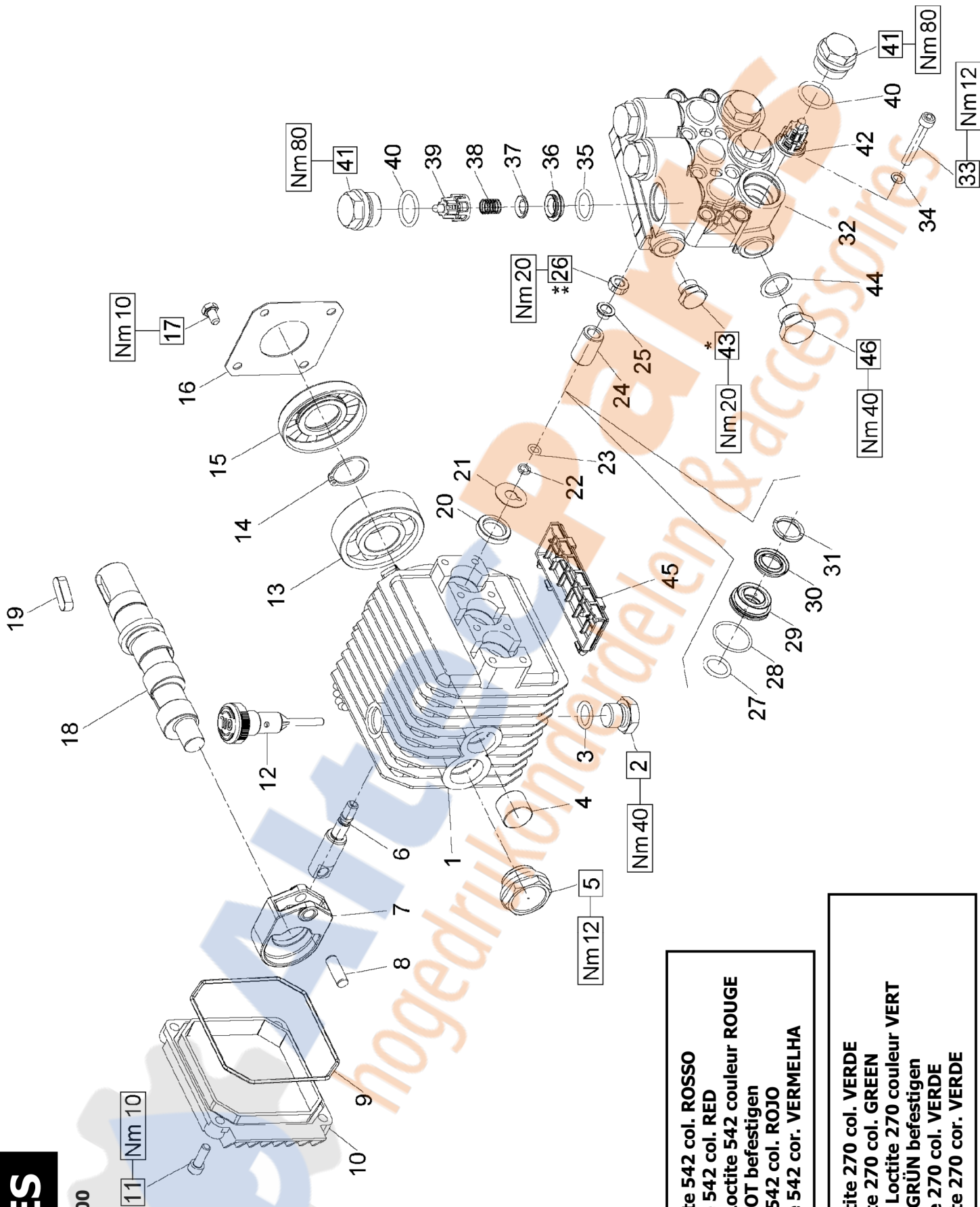

\* Fissare con Loctite 542 col. ROSSO  
 \* Affix with Loctite 542 col. RED  
 \* Fixer avec de la Loctite 542 couleur ROUGE  
 \* Mit Loctite 542 ROT befestigen  
 \* Fijar con Loctite 542 col. ROJO  
 \* Fixar com Loctite 542 cor. VERMELHA

\*\* Fissare con Loctite 270 col. VERDE  
 \*\* Affix with Loctite 270 col. GREEN  
 \*\* Fixer avec de la Loctite 270 couleur VERT  
 \*\* Mit Loctite 270 GRÜN befestigen  
 \*\* Fijar con Loctite 270 col. VERDE  
 \*\* Fixar com Loctite 270 cor. VERDE



**FE5101 – FE5102 – FE5104 - FE5106 – FE5108**

**PISTONE - PISTON Ø 15 PISTONE - PISTON Ø 18**

**FE5101 – FE5102  
FE5104 – FE5106**

**FE5108**

POS	COD.	DESCRIZIONE – DESCRIPTION - KIT	NR
1	51.0106.22	Carter pompa	1
2	98.2100.50	Tappo G 3/8"x13 TE22 Zinc.	1
3	90.3833.00	OR D. 13.95x2.62 nbr 70SH. 3056	1
4	91.8014.00	Boccola a rullini	1
5	97.5968.00	Spia livello olio	1
6	51.0500.56	Guida pistone	3
7	51.0301.22	Biella	3
8	97.7310.00	Spinotto D. 8x24.5	3
9	90.3917.00	OR D. 88.57x2.62 NBR 70SH. 3350	1
10	51.1600.22	Coperchio posteriore	1
11	99.1867.00	Vite M6x18 5931 8.8 Zinc.	4
12	98.2103.00	Tappo carico olio	1
13	91.8328.00	Cuscinetto a sfere	1
14	90.0635.00	Anello d'arresto A25	1
15	90.1641.00	Anello rad. D. 25.0x62.0x10.0	1
16	50.1500.74	Coperchio carter	1
17	99.1807.00	Vite M6x10 5937 8.8 Zinc.	4
18	51.0230.65 51.0200.65 51.0201.65 51.0204.65 51.0220.65	Albero C.3.5 - FE5102 Albero C.6 - FE5104 Albero C.8 - FE5108 Albero C.9.4 - FE5106 Albero C.2 - FE5101	1
19	91.4877.00	Linguetta 8x7x25 UNI 6604	1

**KIT RICAMBI – SPARE KITS**

KIT Nr.	KIT 83	KIT 123	KIT 157	PISTONE - PISTON Ø15			PISTONE - PISTON Ø18		
				KIT 86	KIT 96	KIT 97	KIT 139	KIT 140	KIT 141
Posizioni include Positions included	20	35 - 36 37 - 38 39 (42)	40 - 41	27 - 28 29	27 - 28 29 - 30 31	27 - 28 30 - 31	27 - 28 29 - 30 31	27 - 28 30 - 31	
Nr. Pcs.	3	6	6	3	1	3	3	1	

POS	COD.	DESCRIZIONE – DESCRIPTION - KIT	NR	POS	COD.	DESCRIZIONE – DESCRIPTION - KIT	NR
20	90.1565.00	Anello rad. D. 15.0x24.0x5.0	83	38	94.7376.00	Molla Dm. 9.4x14.8	123
21	96.7070.00	Rosetta D. 9.0x23.0x0.5	3	39	36.2025.51	Guida valvola	123
22	90.5022.00	Anello antiest. D. 6.2x9.0x1.5	3	40	90.3847.00	OR D. 20.24x2.62 NBR 70SH. 3081 157	6
23	90.3573.00	OR D. 5.28x1.78 NBR 70SH. 2021	3	41	98.2216.00	Tappo M24x1.5x11.2	157
24	51.0400.09 51.0401.09	Pistone D. 15x25 Pistone D. 18x25	3	42	36.7115.01	Gruppo valvola aspiraz. / mand.	123
25	44.2115.70	Rosetta con collare D. 8	3	43	98.2041.00	Tappo G 1/4"x9	1
26	92.2216.00	Dado M8x13x5 – INOX	3	44	96.7380.00	Rosetta D. 17.5x23.0x1.5	1
27	90.3835.00 90.3843.00	OR D. 15.08x2.62 NBR 70SH. 119 OR D. 17.86x2.62 NBR 70SH. 123 86-96-97 139-140-141	3	45	51.2090.51	Protezione	1
28	90.3604.00	OR D. 25.12x1.78 NBR SH. 70 2100 86-96-97-139-140-141	3	46	98.2100.00	Tappo G 3/8"x13	1
29	51.0800.70 51.0803.70	Anello di fondo D. 15 Anello di fondo D. 18	3				
30	90.2620.00 90.2681.00	Anello ten. alt. D. 15x25x5/3.1 Anello ten. alt. D. 18x26x5/3	3				
31	51.1000.51 51.1001.51	Anello di testa D. 15 Anello di testa D. 18	3				
32	51.1200.41 51.1204.41	Testata D. 15 Testata D. 18	1				
33	99.1943.00	Vite M6x40 5931 8.8 Zinc.	8				
34	96.6938.00	Rondella D. 6.4x10.0x0.7	8				
35	90.3841.00	OR D. 17.13x2.62 NBR 70SH. 3068	123				
36	36.2003.66	Sede valvola	123				
37	36.2001.76	Valvola sferica	123				