

**DIS. COD. 59.9503.00**

- \* Fissare con Loctite 542 col. ROSSO
- \* Affix with Loctite 542 col. RED
- \* Fixer avec de la Loctite 542 couleur ROUGE
- \* Mit Loctite 542 ROT befestigen
- \* Fijar con Loctite 542 cor. ROJO
- \* Fixar con Loctite 542 cor. VERMELHA

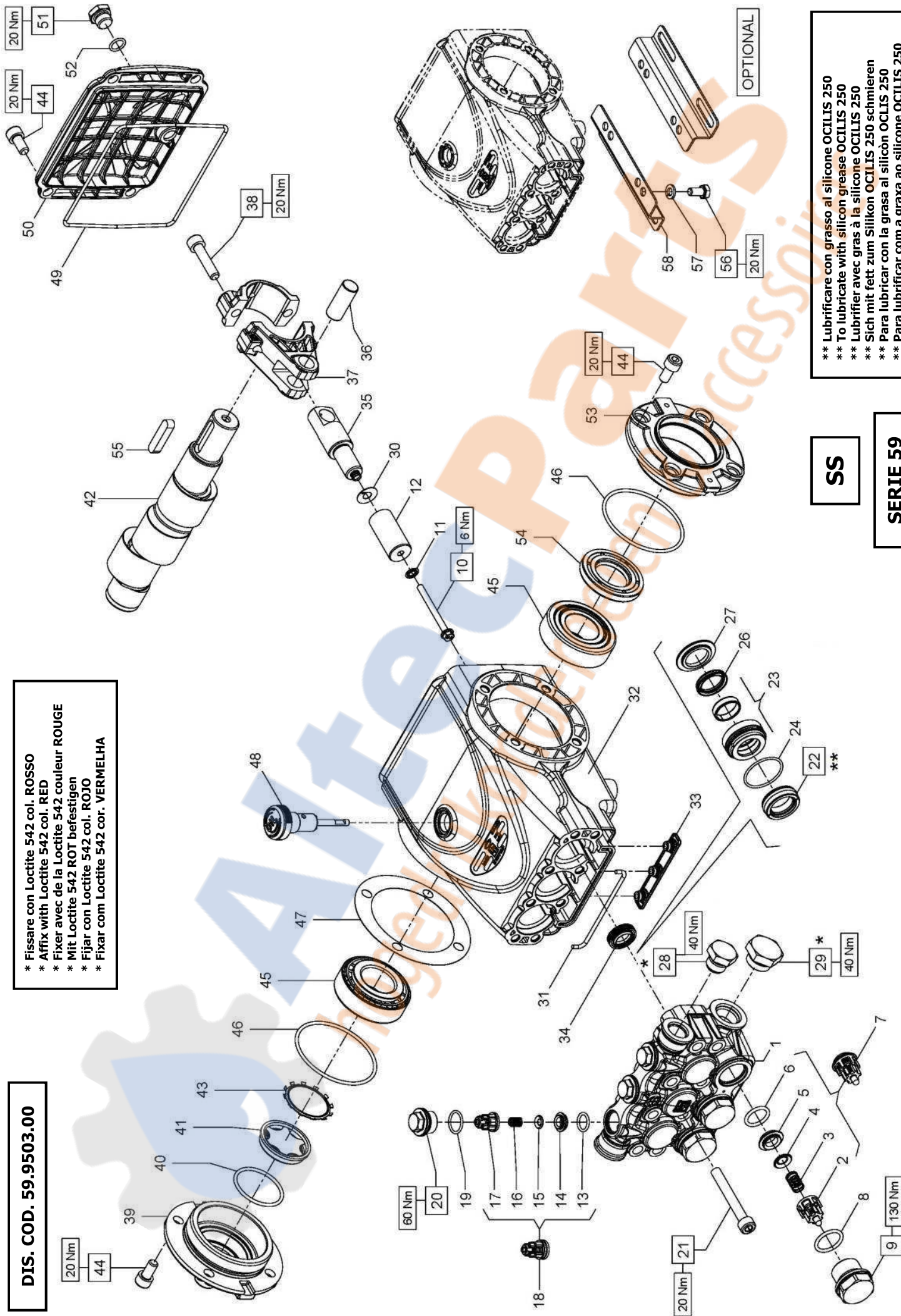

OPTIONAL

**SS**

**SERIE 59**

- \*\* Lubrificare con grasso al silicone OCILIS 250
- \*\* To lubricate with silicon grease OCILIS 250
- \*\* Lubrifier avec gras à la silicone OCILIS 250
- \*\* Sich mit fett zum Silikon OCILIS 250 schmieren
- \*\* Para lubricar con la grasa al silicon OCILIS 250
- \*\* Para lubricar con a graxa ao silicone OCILIS 250



**SS3B2013 - SS3B2015 - SS3B2018**  
**SS3B2021 - SS3C2015 - SS3C2018 - SS3C2021**

| PISTONE - PISTON D. 20                     |                                | PISTONE - PISTON D. 22 |  |
|--|--------------------------------|------------------------|--|
| SS3B2013 - SS3B2015<br>SS3C2015 - SS3C2018 | SS3B2018 - SS3B2021 - SS3C2021 |                        |  |

| POS | COD.                     | DESCRIZIONE - DESCRIPTION - KIT          | NR    |
|-----|--------------------------|--|-------|
| 1   | 59.1222.36<br>59.1223.36 | Testata pompa D.20<br>Testata pompa D.22 | 1     |
| 2   | 36.2025.51               | Guida valvola d'aspirazione              | 341 3 |
| 3   | 94.7373.00               | Molla Dm. 9.4x14.8                       | 341 3 |
| 4   | 36.2001.76               | Valvola sferica d'aspirazione            | 341 3 |
| 5   | 36.2036.66               | Sede valvola d'aspirazione               | 341 3 |
| 6   | 90.3841.00               | OR D.17.13x2.62 NBR SH. 70 3068<br>341   | 3     |
| 7   | 36.7130.01               | Gr. valvola aspirazione                  | 341 3 |
| 8   | 90.3847.00               | OR D.20.24x2.62 NBR 70 SH 3081 349       | 3     |
| 9   | 98.2229.00               | Tappo M24x1.5x17                         | 349 3 |
| 10  | 99.1690.00               | Vite M5x55                               | 3     |
| 11  | 96.6905.00               | Rosetta D. 5.0x11.5x0.4                  | 3     |
| 12  | 59.0400.09<br>59.0401.09 | Pistone D. 20x42<br>Pistone D. 22x42     | 3     |
| 13  | 90.3674.00               | OR D.12.00x2.00 NBR SH. 70               | 334 3 |
| 14  | 53.2111.66               | Sede valvola di mandata                  | 334 3 |
| 15  | 36.2112.76               | Valvola sferica di mandata               | 334 3 |
| 16  | 94.7333.00               | Molla Dm. 6.7x10.4                       | 334 3 |
| 17  | 36.2111.51               | Guida valvola di mandata                 | 334 3 |
| 18  | 36.7245.01               | Gr. valvola di mandata                   | 334 3 |

| KIT RICAMBI - SPARE KITS             |                           |                                 |         |         |         | PISTON D. 20  |                         | PISTON D. 22  |                         |
|--------------------------------------|---------------------------|---------------------------------|---------|---------|---------|---------------|-------------------------|---------------|-------------------------|
| KIT Nr.                              | KIT 341                   | KIT 334                         | KIT 349 | KIT 336 | KIT 271 | KIT 350       | KIT 351                 | KIT 352       | KIT 353                 |
| Posizioni include Positions included | 2 - 3 - 4<br>5 - 6<br>(7) | 13 - 14 - 15<br>16 - 17<br>(18) | 8 - 9   | 19 - 20 | 34      | 22 - 24<br>26 | 22 - 23 - 24<br>26 - 27 | 22 - 24<br>26 | 22 - 23 - 24<br>26 - 27 |
| Nr. Pcs.                             | 3                         | 3                               | 3       | 3       | 3       | 3             | 1                       | 3             | 1                       |

| POS | COD.                     | DESCRIZIONE - DESCRIPTION - KIT  | NR    | POS | COD.                                   | DESCRIZIONE - DESCRIPTION - KIT  | NR |
|-----|--------------------------|--|-------|-----|--|--|----|
| 19  | 90.3593.00               | OR D.15.60x1.78 NBR 70 SH 2062 336   | 3     | 39  | 59.1502.22                             | Coperchio laterale spia  | 1  |
| 20  | 98.2137.20               | Tappo M18x1.5x10   | 336 3 | 40  | 90.3877.00                             | OR D. 39.34x2.62 NBR 70 SH. 3156   | 1  |
| 21  | 99.3176.00               | Vite M8x60 UNI 5931  | 8     | 41  | 70.2118.01                             | Spia livello olio  | 1  |
| 22  | 90.2260.00<br>90.2312.00 | An. ten. alt. D. 20.0x30.0x10 HP<br>350 351<br>An. ten. alt. D. 22.0x32.0x10 HP<br>352 353 | 3     | 42  | 59.0201.35<br>59.0202.35<br>59.0203.35 | Albero ecc. C.13 - SS3B2021<br>Albero ecc. C.12 - SS3B2015 SS3B2018<br>SS3C2018 SS3C2021<br>Albero ecc. C.10 - SS3B2013 SS3C2015 | 1  |
| 23  | 59.6064.01<br>59.6065.01 | Gr. supp. guarn./boccola D.20<br>351<br>Gr. supp. guarn./boccola D.22<br>353               | 3     | 43  | 90.0756.00                             | Anello d'arresto ZJ45  | 1  |
| 24  | 90.3612.00               | OR D. 31.47x1.78 NBR 70 SH. 2125<br>350 351 352 353  | 3     | 44  | 99.3038.00                             | Vite M8x16 UNI 5931  | 12 |
| 26  | 90.2250.00<br>90.2300.00 | Anello ten. alt. D. 20x26.15 LP 350 351<br>Anello ten. alt. D. 22x26.15 LP 352 353         | 3     | 45  | 91.8375.00                             | Cuscinetto a rulli   | 2  |
| 27  | 59.2115.56<br>59.2116.56 | Anello per tenuta D. 20<br>351<br>Anello per tenuta D. 22<br>353                           | 3     | 46  | 90.3913.00                             | OR D. 67.95x2.62 NBR SH. 70 3628   | 2  |
| 28  | 98.2100.66               | Tappo G 3/8"x13  | 1     | 47  | 97.5678.00<br>97.5680.00               | Spessore D. 74.5x104.0x0.1<br>Spessore D. 74.5x104.0x0.3   | 1  |
| 29  | 98.2180.00               | Tappo G 1/2"x10  | 1     | 48  | 98.2105.00                             | Asta livello olio G 3/8"x51  | 1  |
| 30  | 96.6990.00               | Rosetta D. 7.5x23.0x0.5  | 3     | 49  | 90.3922.00                             | OR D. 133.02x2.62 NBR SH. 70 3525  | 1  |
| 31  | 59.2110.82               | Guarnizione spugna D. 3x103  | 1     | 50  | 59.1601.22                             | Coperchio posteriore   | 1  |
| 32  | 59.0101.22               | Carter pompa   | 1     | 51  | 98.2040.00                             | Tappo G 1/4"x9   | 1  |
| 33  | 58.2104.51               | Protezione   | 1     | 52  | 90.3585.00                             | OR D. 10.82x1.78 NBR SH. 70 2043   | 1  |
| 34  | 90.1565.50               | Anello rad. D. 15.0x24.0x5.0/7.0 271   | 3     | 53  | 59.1501.22                             | Coperchio laterale aperto  | 1  |
| 35  | 59.0501.66               | Guida pistone  | 3     | 54  | 90.1648.00                             | Anello rad. D. 30.0x55.0x7.0   | 1  |
| 36  | 97.7399.00               | Spinotto D. 14x34  | 3     | 55  | 91.4892.00                             | Linguetta 8x7x35   | 1  |
| 37  | 59.0300.01               | Biella   | 3     | 56  | 99.3037.00                             | Vite M 8x16 UNI 5739   | 4  |
| 38  | 99.3099.00               | Vite serraggio biella M 8x35   | 6     | 57  | 96.7016.00                             | Rosetta D. 8.4 UNI 1751  | 4  |
|     |                          |  |       | 58  | 50.2000.74                             | Piedino pompa  | 2  |