

W131



INFORMAZIONI TECNICHE - TECHNICAL INFORMATION

| | | |
|--------------------------------------|-----------------------------------|---------------|
| Portata (L/min) | Flow (L/min) | 15 |
| Portata (US Gpm) | Flow (US Gpm) | 3,96 |
| Regime di rotazione (rpm) | Rotation regime (rpm) | 1000 |
| Pressione (MPa) | Pressure (MPa) | 13 |
| Pressione (bar) | Pressure (bar) | 130 |
| Pressione (psi) | Pressure (psi) | 1885 |
| Potenza (hp) | Power (hp) | 5,5 |
| Potenza (kW) | Power (kW) | 4,04 |
| Dimensioni d'ingombro L x l x h (mm) | Overall dimensions L x l x h (mm) | 317,5x236x180 |
| Peso (kg) | Weight (kg) | 14,5 |

W131

VERSIONI - VERSIONS

| | | |
|--|------|---|
| Albero maschio con linguetta - Male shaft (key) | Pag. | 3 |
| Albero maschio doppia presa di forza con linguetta - Double male shaft (key) | Pag. | 6 |

Albero maschio con linguetta - Male shaft (key)

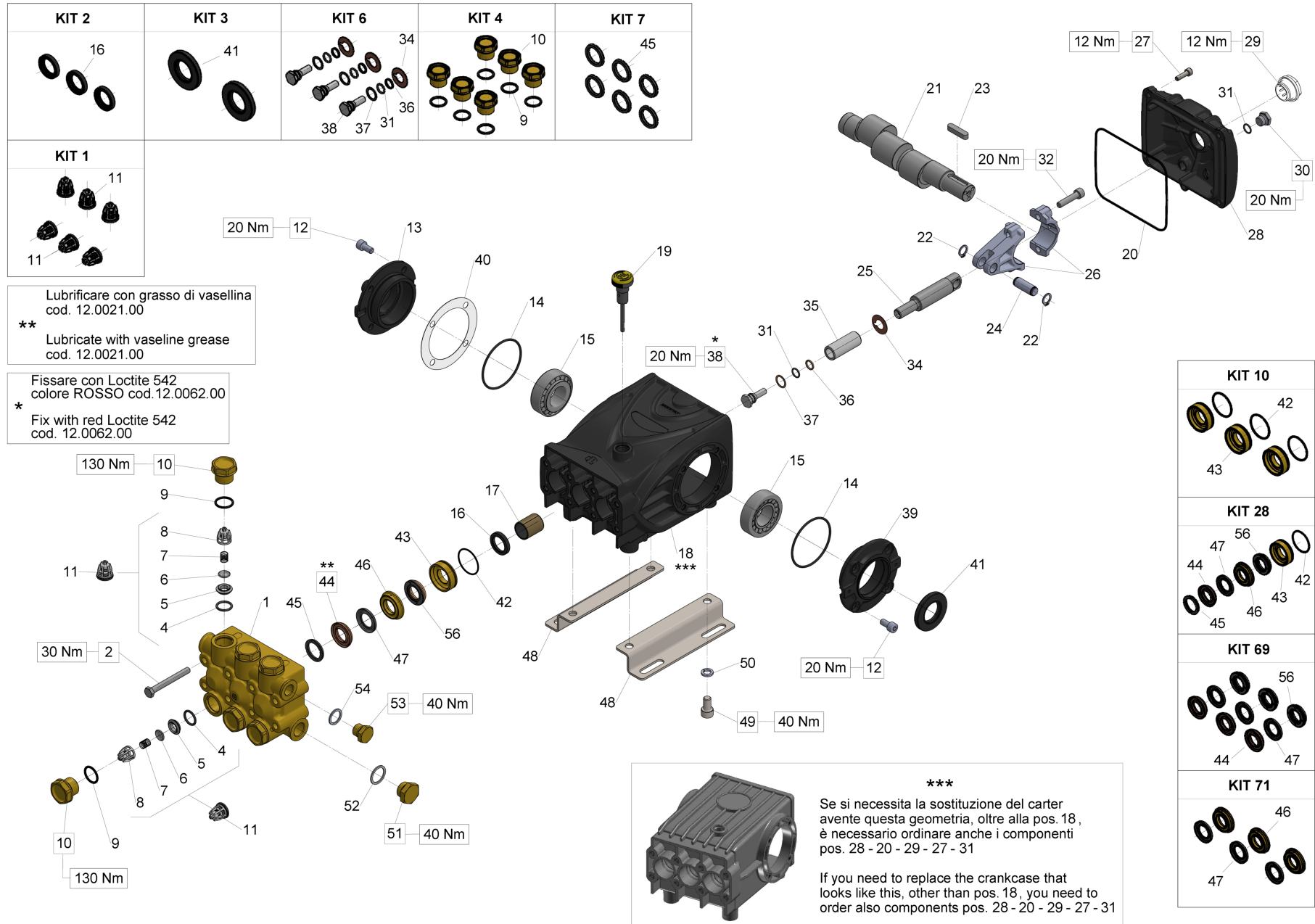

Albero maschio con linguetta - Male shaft (key)

| Ref. | Codice - Part n° | Qtà - Qty | Descrizione | Description |
|------|------------------|-----------|--------------------------------------|---|
| 1 | 47120141 | 1 | TESTATA POMPA D.20-22-24 | MANIFOLD |
| 2 | 99320600 | 8 | VITE TE M8X70 UNI5737 10.9 ZB | HEX-HEAD SCREW M08X70 UNI5737 10.9 Fe/Zn5c1A+De |
| 4 | 90384100 | 6 | OR D.17,13X2,62 (3068) | O-RING 17,12X2,62 (3068) |
| 5 | 36200366 | 6 | SEDE VALVOLA ASP. E MANDATA | VALVE SEAT |
| 6 | 36200176 | 6 | VALVOLA SFERICA | VALVE PLATE |
| 7 | 94737600 | 6 | MOLLA DM 9,4X14,8 INOX | SPRING D. 9,4X14,8 |
| 8 | 36200251 | 6 | GUIDA VALVOLA ASP. MANDATA | VALVE CAGE |
| 9 | 90384700 | 6 | OR D.20,24X2,62 (3081) | O-RING 20,29X2,62(3081) |
| 10 | 98222000 | 6 | TAPPO M24X2X16.5 | CAP M24X2X16 |
| 11 | 36703201 | 6 | GR. VALVOLA ASP. MAND. | VALVE ASSY. |
| 12 | 99303900 | 8 | VITE TCEI M8X16 ZINC. UNI5931 | SCREW M 8x16 UNI 5931 |
| 13 | 47151122 | 1 | COPERCHIO LAT. CHIUSO S.47-66 | CLOSED SIDE COVER (47-66) |
| 14 | 90391300 | 2 | OR D.67,95X2,62 (3268) | O-RING 67,95X2,62 (3268) |
| 15 | 91837500 | 2 | CUSC. RULLI CON. 30X62X21.25-32206 | TAPER BEARING |
| 16 | 90162500 | 3 | ANELLO RADIALE D.22X32X5 | OIL SEAL 22x32x5 |
| 17 | 90912600 | 3 | BOCCOLA D.22X25X30 | BUSHING 22X25X30 |
| 18 | 47010822 | 1 | CARTER POMPA | CRANKCASE |
| 19 | 98210600 | 1 | ASTA LIV. OLIO G3/8X64 COMPL. | OIL DIP-STICK G3/8X80 |
| 20 | 90392200 | 1 | OR D.133,02X2,62 (3525) | O-RING D.133.02X 2,62(3525) |
| 21 | 47021735 | 1 | ALBERO ECC.C.16 SPDF 24x40 (marc. 8) | CRANKSHAFT C.16 S.p.f. U.S. |
| 22 | 90055700 | 6 | ANELLO SEEGER ALBERI UNI 7435-12 | CIRCLIP D.12 UNI 7435 |
| 23 | 91489200 | 1 | LINGUETTA 8X7X35 | KEY 8(h9)X7X35 UNI 6604/A |
| 24 | 97738000 | 3 | SPINOTTO D.13X35.5 | CONNECTING-ROD PIN D.13X35,5 |
| 25 | 47050466 | 3 | GUIDA PISTONE - INOX | PISTON GUIDE - S.S. |
| 26 | 47030001 | 3 | BIELLA COMPLETA | CONNECTING ROD |
| 27 | 99188400 | 5 | VITE TCEI M6X20 8.8 ZINCATA | SCREW M 6x20 UNI 5931 |
| 28 | 47160622 | 1 | COPERCHIO POSTERIORE | CRANKCASE COVER |
| 29 | 47221301 | 1 | GRUPPO SPIA LIVELLO OLIO G3/4 | OIL SIGHT GLASS ASSY G3/4 |
| 30 | 98204250 | 1 | TAPPO G1/4X9 TE17 ZINC. | PLUG G1/4"x12 |
| 31 | 90358500 | 4 | OR D.10,82X1,78 (2043) | O-RING 10,82X1,78 (2043) |
| 32 | 99309900 | 6 | VITE TCEI M8X35 | SCREW M 8x35 UNI 5931 |
| 34 | 96728600 | 3 | ROSETTA D.14X28X0,5 CU | WASHER 14X28X0,5 |
| 35 | 47040409 | 3 | PISTONE D.20x50 | PISTON D. 20x50 |
| 36 | 90506700 | 3 | ANELLO ANTIES.D.11X14X1.5 | ANTI-EXTRUSION RING |

Albero maschio con linguetta - Male shaft (key)

| Ref. | Codice - Part n° | Qtà - Qty | Descrizione | Description |
|-------|------------------|-----------|--------------------------------------|--------------------------------|
| 37 | 96728000 | 3 | ROSETTA D.14X18.5X0.5 | WASHER 14X18,5X0,5 |
| 38 | 47219566 | 3 | VITE FISSAGGIO PISTONE | PISTON SCREW |
| 39 | 47151022 | 1 | COPERCHIO LAT. APERTO S.47-66 | OPEN SIDE COVER (47-66) |
| 40 | 97567800 | 1 | SPESSORE D. 74,5X104X0,1 | SHIM D.74,5X104X0,1 |
| 40 | 97568000 | 1 | SPESSORE D.74,5X104X0,3 | SHIM D.74.5X104X0.3 |
| 41 | 90164800 | 1 | ANELLO RAD. D.30X55X7 | OIL SEAL 30x55x7 |
| 42 | 90361600 | 3 | OR D.34,65X1,78 (2137) | O-RING 34,65X1,78 (2137) |
| 43 | 47080570 | 3 | ANELLO DI FONDO D.20 | PACKING RETAINER D. 20x35 |
| 44 | 90270500 | 3 | ANELLO TEN.D.20X35X7.5/4.5H.P. | PACKING 20x35x7,5 |
| 45 | 47100051 | 3 | ANELLO DI TESTA D.20 | HEAD RING D. 20 |
| 46 | 47216970 | 3 | ANELLO INTERMEDIO D.20 | INTERM.RING D. 20 (SPEC.) |
| 47 | 90270400 | 3 | ANELLO "RESTOP" 20X35X5.5/2 | RESTOP RING D. 20 TYPE 6/1 |
| 48 | 47200074 | 2 | PIEDINO FISSAGGIO POMPA | PUMP FOOT |
| 49 | 99364400 | 4 | VITE TCEI M10X18 8.8 ZINCATA UNI5931 | SCREW M 10x18-5931 |
| 50 | 96710600 | 4 | RONDELLA D.10 UNI1751 | WASHER 10,2 |
| 51 | 98217600 | 1 | TAPPO G 1/2X10 | PLUG G1/2X10 |
| 52 | 96751400 | 1 | ROSETTA D.21,5X27X1,5 | WASHER 21,5X27X1,5 |
| 53 | 98210000 | 1 | TAPPO G 3/8X13 | PLUG G3/8X13 |
| 54 | 96738000 | 1 | ROSETTA D.17,5X23X1,5 AL. | WASHER 17,5X23X1,5 |
| 56 | 90271000 | 3 | ANELLO TEN.ALT.20X35X8.7 L.P | PACKING D.20X35X9 L.P. |
| KIT1 | 34000101 | 1 | KIT 1 | KIT 1 INTAKE/DELIVERY VALVE |
| KIT2 | 34000201 | 1 | KIT 2 | KIT 2 OIL SEAL D. 22X32X5,5 |
| KIT3 | 34000301 | 1 | KIT 3 | KIT 3 OIL SEAL D.30X55X7 |
| KIT4 | 34000401 | 1 | KIT 4 | KIT 4 INTAKE/DEL. VALVE CAPS |
| KIT6 | 34000601 | 1 | KIT 6 | KIT 6 PISTON BOLT |
| KIT7 | 34000701 | 1 | KIT 7 | KIT 7 HEAD RING D.20 |
| KIT10 | 34001001 | 1 | KIT 10 | KIT 10 PACKING RETAINER D.20 |
| KIT28 | 34002801 | 1 | KIT 28 | KIT 28 COMPL.SEAL FOR PIST.D20 |
| KIT69 | 34006901 | 1 | KIT 69 | KIT 69 PACKING D.20 W/RESTOP |
| KIT71 | 34007101 | 1 | KIT 71 | KIT 71 INTERMEDIATE RING D.20 |

Albero maschio doppia presa di forza con linguetta - Double male shaft (key)

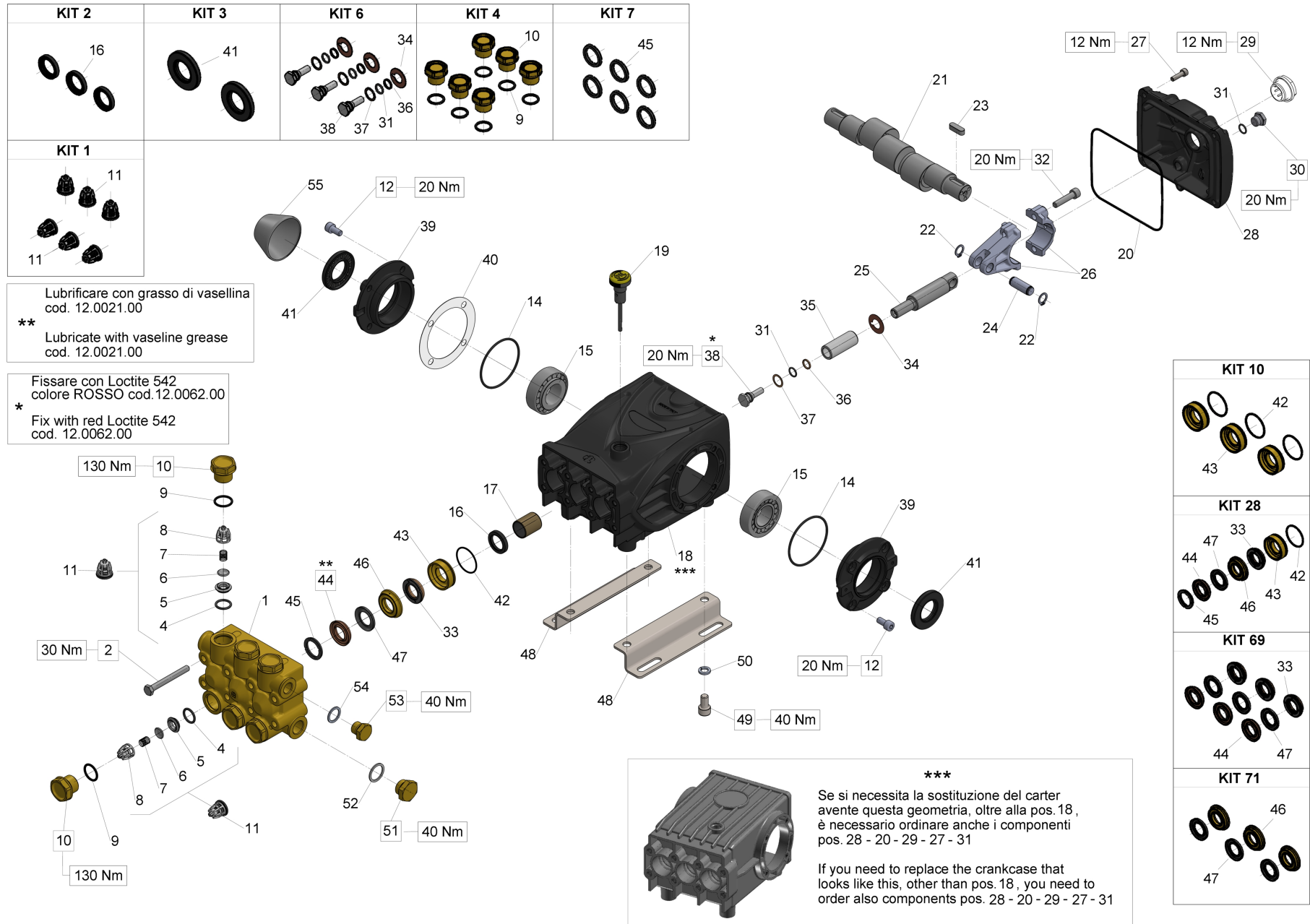

Albero maschio doppia presa di forza con linguetta - Double male shaft (key)

| Ref. | Codice - Part n° | Qtà - Qty | Descrizione | Description |
|------|------------------|-----------|--------------------------------------|---|
| 1 | 47120141 | 1 | TESTATA POMPA D.20-22-24 | MANIFOLD |
| 2 | 99320600 | 8 | VITE TE M8X70 UNI5737 10.9 ZB | HEX-HEAD SCREW M08X70 UNI5737 10.9 Fe/Zn5c1A+De |
| 4 | 90384100 | 6 | OR D.17,13X2,62 (3068) | O-RING 17,12X2,62 (3068) |
| 5 | 36200366 | 6 | SEDE VALVOLA ASP. E MANDATA | VALVE SEAT |
| 6 | 36200176 | 6 | VALVOLA SFERICA | VALVE PLATE |
| 7 | 94737600 | 6 | MOLLA DM 9,4X14,8 INOX | SPRING D. 9,4X14,8 |
| 8 | 36200251 | 6 | GUIDA VALVOLA ASP. MANDATA | VALVE CAGE |
| 9 | 90384700 | 6 | OR D.20,24X2,62 (3081) | O-RING 20,29X2,62(3081) |
| 10 | 98222000 | 6 | TAPPO M24X2X16.5 | CAP M24X2X16 |
| 11 | 36703201 | 6 | GR. VALVOLA ASP. MAND. | VALVE ASSY. |
| 12 | 99303900 | 8 | VITE TCEI M8X16 ZINC. UNI5931 | SCREW M 8x16 UNI 5931 |
| 14 | 90391300 | 2 | OR D.67,95X2,62 (3268) | O-RING 67,95X2,62 (3268) |
| 15 | 91837500 | 2 | CUSC. RULLI CON. 30X62X21.25-32206 | TAPER BEARING |
| 16 | 90162500 | 3 | ANELLO RADIALE D.22X32X5 | OIL SEAL 22x32x5 |
| 17 | 90912600 | 3 | BOCCOLA D.22X25X30 | BUSHING 22X25X30 |
| 18 | 47010822 | 1 | CARTER POMPA | CRANKCASE |
| 19 | 98210600 | 1 | ASTA LIV. OLIO G3/8X64 COMPL. | OIL DIP-STICK G3/8X80 |
| 20 | 90392200 | 1 | OR D.133,02X2,62 (3525) | O-RING D.133.02X 2,62(3525) |
| 21 | 47020035 | 1 | ALBERO ECC.C.16 DPDF 24x30 (marc. 8) | CRANKSHAFT C.16 D.p.f. |
| 22 | 90055700 | 6 | ANELLO SEEGER ALBERI UNI 7435-12 | CIRCLIP D.12 UNI 7435 |
| 23 | 91487700 | 1 | LINGUETTA 08x07x025 UNI6604/A (51) | KEY 8(h9)X7X25 UNI 6604/A |
| 24 | 97738000 | 3 | SPINOTTO D.13X35.5 | CONNECTING-ROD PIN D.13X35,5 |
| 25 | 47050466 | 3 | GUIDA PISTONE - INOX | PISTON GUIDE - S.S. |
| 26 | 47030001 | 3 | BIELLA COMPLETA | CONNECTING ROD |
| 27 | 99188400 | 5 | VITE TCEI M6X20 8.8 ZINCATA | SCREW M 6x20 UNI 5931 |
| 28 | 47160622 | 1 | COPERCHIO POSTERIORE | CRANKCASE COVER |
| 29 | 47221301 | 1 | GRUPPO SPIA LIVELLO OLIO G3/4 | OIL SIGHT GLASS ASSY G3/4 |
| 30 | 98204250 | 1 | TAPPO G1/4X9 TE17 ZINC. | PLUG G1/4"x12 |
| 31 | 90358500 | 4 | OR D.10,82X1,78 (2043) | O-RING 10,82X1,78 (2043) |
| 32 | 99309900 | 6 | VITE TCEI M8X35 | SCREW M 8x35 UNI 5931 |
| 33 | 90271000 | 3 | ANELLO TEN.ALT.20X35X8.7 L.P | PACKING D.20X35X9 L.P. |
| 34 | 96728600 | 3 | ROSETTA D.14X28X0,5 CU | WASHER 14X28X0,5 |
| 35 | 47040409 | 3 | PISTONE D.20x50 | PISTON D. 20x50 |
| 36 | 90506700 | 3 | ANELLO ANTIES.D.11X14X1.5 | ANTI-EXTRUSION RING |
| 37 | 96728000 | 3 | ROSETTA D.14X18.5X0.5 | WASHER 14X18,5X0,5 |
| 38 | 47219566 | 3 | VITE FISSAGGIO PISTONE | PISTON SCREW |

Albero maschio doppia presa di forza con linguetta - Double male shaft (key)

| Ref. | Codice - Part n° | Qtà - Qty | Descrizione | Description |
|-------|------------------|-----------|--------------------------------------|--------------------------------|
| 39 | 47151022 | 2 | COPERCHIO LAT. APERTO S.47-66 | OPEN SIDE COVER (47-66) |
| 40 | 97567800 | 1 | SPESSORE D. 74,5X104X0,1 | SHIM D.74,5X104X0,1 |
| 40 | 97568000 | 1 | SPESSORE D.74,5X104X0,3 | SHIM D.74.5X104X0.3 |
| 41 | 90164800 | 2 | ANELLO RAD. D.30X55X7 | OIL SEAL 30x55x7 |
| 42 | 90361600 | 3 | OR D.34,65X1,78 (2137) | O-RING 34,65X1,78 (2137) |
| 43 | 47080570 | 3 | ANELLO DI FONDO D.20 | PACKING RETAINER D. 20x35 |
| 44 | 90270500 | 3 | ANELLO TEN.D.20X35X7,5/4.5H.P. | PACKING 20x35x7,5 |
| 45 | 47100051 | 3 | ANELLO DI TESTA D.20 | HEAD RING D. 20 |
| 46 | 47216970 | 3 | ANELLO INTERMEDIO D.20 | INTERM.RING D. 20 (SPEC.) |
| 47 | 90270400 | 3 | ANELLO "RESTOP" 20X35X5,5/2 | RESTOP RING D. 20 TYPE 6/1 |
| 48 | 47200074 | 2 | PIEDINO FISSAGGIO POMPA | PUMP FOOT |
| 49 | 99364400 | 4 | VITE TCEI M10X18 8.8 ZINCATA UNI5931 | SCREW M 10x18-5931 |
| 50 | 96710600 | 4 | RONDELLA D.10 UNI1751 | WASHER 10,2 |
| 51 | 98217600 | 1 | TAPPO G 1/2X10 | PLUG G1/2X10 |
| 52 | 96751400 | 1 | ROSETTA D.21,5X27X1,5 | WASHER 21,5X27X1,5 |
| 53 | 98210000 | 1 | TAPPO G 3/8X13 | PLUG G3/8X13 |
| 54 | 96738000 | 1 | ROSETTA D.17,5X23X1,5 AL. | WASHER 17,5X23X1,5 |
| 55 | 47212451 | 1 | CAPPELOTTO PROTEZ.P.D.F. | SHAFT PROTECTOR |
| KIT1 | 34000101 | 1 | KIT 1 | KIT 1 INTAKE/DELIVERY VALVE |
| KIT2 | 34000201 | 1 | KIT 2 | KIT 2 OIL SEAL D. 22X32X5,5 |
| KIT3 | 34000301 | 1 | KIT 3 | KIT 3 OIL SEAL D.30X55X7 |
| KIT4 | 34000401 | 1 | KIT 4 | KIT 4 INTAKE/DEL. VALVE CAPS |
| KIT6 | 34000601 | 1 | KIT 6 | KIT 6 PISTON BOLT |
| KIT7 | 34000701 | 1 | KIT 7 | KIT 7 HEAD RING D.20 |
| KIT10 | 34001001 | 1 | KIT 10 | KIT 10 PACKING RETAINER D.20 |
| KIT28 | 34002801 | 1 | KIT 28 | KIT 28 COMPL.SEAL FOR PIST.D20 |
| KIT69 | 34006901 | 1 | KIT 69 | KIT 69 PACKING D.20 W/RESTOP |
| KIT71 | 34007101 | 1 | KIT 71 | KIT 71 INTERMEDIATE RING D.20 |