

E3B2118



INFORMAZIONI TECNICHE - TECHNICAL INFORMATION

Portata (L/min)	Flow (L/min)	18
Portata (US Gpm)	Flow (US Gpm)	4,76
Regime di rotazione (rpm)	Rotation regime (rpm)	1450
Pressione (MPa)	Pressure (MPa)	21
Pressione (bar)	Pressure (bar)	210
Pressione (psi)	Pressure (psi)	3045
Potenza (hp)	Power (hp)	9,8
Potenza (kW)	Power (kW)	7,21
Dimensioni d'ingombro L x l x h (mm)	Overall dimensions L x l x h (mm)	265x223x140
Peso (kg)	Weight (kg)	9,5

E3B2118

VERSIONI - VERSIONS

Albero maschio con linguetta - Male shaft (key)	Pag.	3
Testata con valvola integrata VH - Pump head with VH integrated valve	Pag.	6

Albero maschio con linguetta - Male shaft (key)

Ref.	Codice - Part n°	Qtà - Qty	Descrizione	Description
1	59121441	1	TESTATA POMPA D.22 NICKEL (E3)	MANIFOLD D.22 *NICKEL PL.
2	36202551	3	GUIDA VALVOLA ASP. MANDATA	VALVE CAGE
3	94737600	3	MOLLA DM 9,4X14,8 INOX	SPRING D. 9,4X14,8
4	36200176	3	VALVOLA SFERICA	VALVE PLATE
5	36200366	3	SEDE VALVOLA ASP. E MANDATA	VALVE SEAT
6	90384100	3	OR D.17,13X2,62 (3068)	O-RING 17,12X2,62 (3068)
7	36711501	3	GR. VALVOLA ASP. MAND.	INTAKE/DELIVERY VALVE
8	90384700	3	OR D.20,24X2,62 (3081)	O-RING 20,29X2,62(3081)
9	98222500	3	TAPPO M24x1.5x16.7 NICKEL	VALVE CAP M24X1,5X17 NICKEL
10	99169000	3	VITE TE M5X55 INOX A2 FLANGIATA	SCREW M05X55 SPEC. A2-70
11	96690500	3	ROSETTA D.5X11,5X0,4 INOX+FKM	WASHER D.5X11.5x0.4 INOX+FKM58/59/63HT
12	59040109	3	PISTONE D.22x42	PISTON D.22X42
13	90367400	3	OR D.12X2 (120-20)	O-RING D. 12X2 (120-20)
14	36211366	3	SEDE VALVOLA	VALVE SEAT
15	36211276	3	VALVOLA SFERICA	SPHERICAL VALVE
16	94733300	3	MOLLA DM.6.7X10.8 INOX	SPRING D.6.2x10.5 S.S.
17	36211151	3	GUIDA VALVOLA ASP.MANDATA	VALVE CAGE
18	36719301	3	GRUPPO VALVOLA MANDATA	OUTLET VALVE
19	98196700	1	TAPPO G1/8x8 NICKEL	PLUG G 1/8 X 8 NICKEL
20	90359300	3	OR D.15.60X1.78 (2062)	O-RING 15,60X1,78 (2062)
21	98213750	3	TAPPO M18x1.5x10 D23 F12 NICK. (S.59)	PLUG M18X1,5X10 D.23 (NICK.)
22	99317700	8	VITE M08x60 5931 12.9 G321A+M	VITE M08x60 5931 12.9 G321A+M
23	66100951	3	ANELLO DI TESTA D.22 HP	HEAD RING D. 22 H.P.
24	90271600	3	ANELLO TEN.ALT.22.0x32x6/3.7 HP 66	PACKING D.22X32X6/3.7 H.P. 66 SERIES
25	90514850	3	ANELLO ANTIEST. 22.0x32.0x2.0 SERIE 59	ANTI-EXTRUSION RING D.22X32X2
26	59606201	3	GR. SUPP. GUARN + BOCCOLA D.22	PACKING RETAINER+SLEEVE D.22
27	90361200	3	OR D. 31.47x1.78 NBR 70SH 2125	O-RING 31,47X1,78 (2125)
29	90271500	3	ANELLO TEN.ALT.22.0x30x6.5 LP 66	PACKING D.22X30X6.5 LP (66)
30	59210970	3	ANELLO PER TENUTA D.22	RING FOR SEAL D.22
31	98209900	1	TAPPO G3/8x13 NICKEL	PLUG G. 3/8X13 NICKEL
32	96738000	1	ROSETTA D.17,5X23X1,5 AL.	WASHER 17,5X23X1,5
33	98217900	1	TAPPO G1/2x10 NICKEL	PLUG G 1/2X10 NICKEL
34	96751400	1	ROSETTA D.21,5X27X1,5	WASHER 21,5X27X1,5
35	96699000	3	ROSETTA D.7,5X23X0,5 INOX	WASHER D.7.5X23X0.5
36	59211082	1	GUARNIZIONE SPUGNA D.3X103	SPONGE GASKET D.3X103
37	59010022	1	CARTER POMPA	PUMP CRANKCASE

Albero maschio con linguetta - Male shaft (key)

Ref.	Codice - Part n°	Qtà - Qty	Descrizione	Description
38	58210451	1	PROTEZIONE	PROTECTION
39	90156550	3	ANELLO RAD. D.15X24X5/7	OIL SEAL D.15X24X5/7
40	59050066	3	GUIDA PISTONE	PISTON GUIDE
41	97739900	3	SPINOTTO D.14.0x34.0 (S.59)	GUDGEON PIN D.14X34
42	59030001	3	BIELLA COMPLETA	CONNECTING ROD COMPLETE
43	99309900	6	VITE TCEI M8X35	SCREW M 8x35 UNI 5931
44	47151222	1	COPERCHIO LATERALE SPIA 47-66	SIDE CRANKCASE COVER FOR OIL GAUGE
45	90387700	1	OR D.39,34X2,62 (3156)	O-RING 39,34X2,62 (3156)
46	70211801	1	SPIA LIVELLO OLIO	OIL SIGHT GLASS
47	59020235	1	ALBERO ECC. C.12 (D.24) (marc. 6)	CRANKSHAFT C.12
48	90075600	1	ANELLO ZI45	CIRCLIP D.45 (ZI45)
49	99303900	12	VITE TCEI M8X16 ZINC. UNI5931	SCREW M 8x16 UNI 5931
50	91837500	2	CUSC. RULLI CON. 30X62X21.25-32206	TAPER BEARING
51	90391300	2	OR D.67,95X2,62 (3268)	O-RING 67,95X2,62 (3268)
52	97568000	1	SPESSORE D.74,5X104X0,3	SHIM D.74.5X104X0.3
52	97567800	1	SPESSORE D. 74,5X104X0,1	SHIM D.74,5X104X0,1
53	98211300	1	ASTA LIVELLO OLIO G3/8x54 D.4	ASTA LIVELLO OLIO G3/8x54 D.4
54	90392200	1	OR D.133,02X2,62 (3525)	O-RING D.133.02X 2,62(3525)
55	59160022	1	COPERCHIO POSTERIORE	REAR CRANKCASE COVER
56	98204250	1	TAPPO G1/4X9 TE17 ZINC.	PLUG G1/4"x12
57	90358500	1	OR D.10,82X1,78 (2043)	O-RING 10,82X1,78 (2043)
58	47151022	1	COPERCHIO LAT. APERTO S.47-66	OPEN SIDE COVER (47-66)
59	90164800	1	ANELLO RAD. D.30X55X7	OIL SEAL 30x55x7
60	91489200	1	LINGUETTA 8X7X35	KEY 8(h9)X7X35 UNI 6604/A
61	99303700	4	VITE M08X16 5739 8.8 ZINC	SCREW M 8x16-5739
62	96701600	4	ROSETTA 8.4x14.4x2.0 U1751 ZINC RICH.1	WASHER 8,4
63	50200074	2	PIEDINO POMPA R.52-9961	PUMP FOOT
KIT269	34026901	1	KIT 269	KIT 269 INTAKE/DELIVERY VALVES
KIT271	34027101	1	KIT 271	KIT 271 OIL SEAL D.15 58/59 SERIES
KIT286	34028601	1	KIT 286*ANELLI DI TENUTA D.22 (59)	KIT 286 PACKING D.22 58 SERIES
KIT291	34029101	1	KIT 291*TENUTA COMPLETA D.22 (59)	KIT 291*TENUTA COMPLETA D.22 (59)
KIT292	34029201	1	KIT 292*GR. TAPPI ASP. MAND. NK (58-59)	KIT 292 VALVE PLUGS (NICK.)59 S.

Testata con valvola integrata VH - Pump head with VH integrated valve

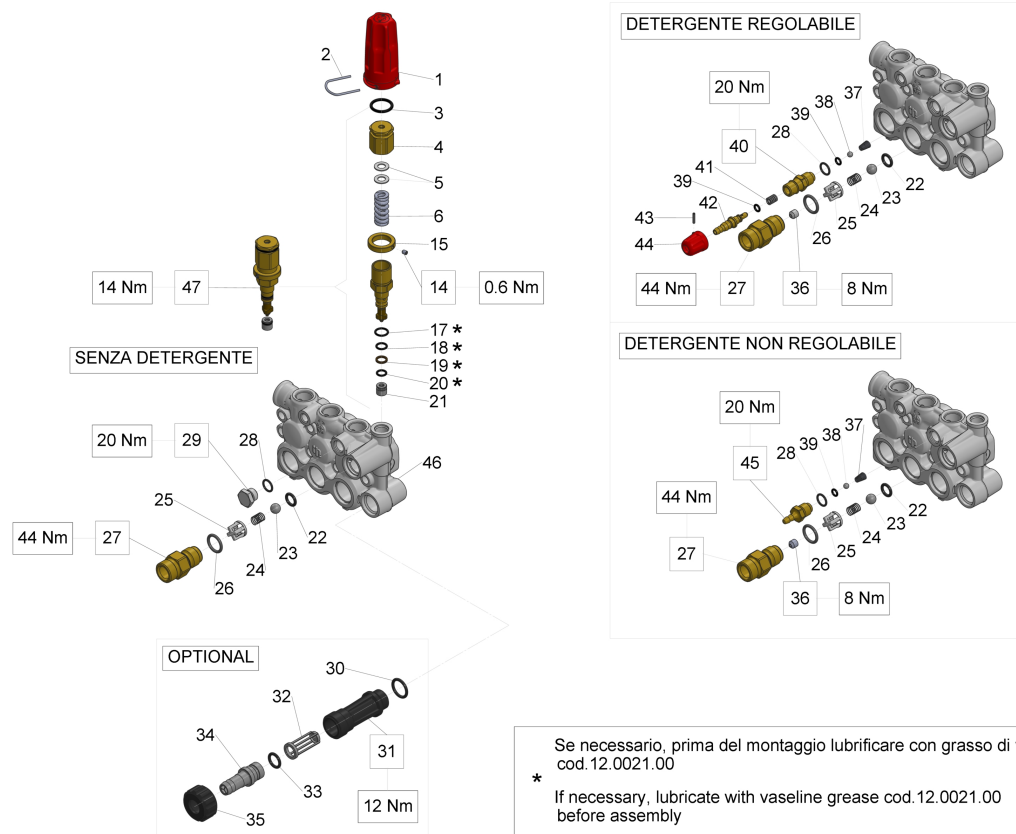
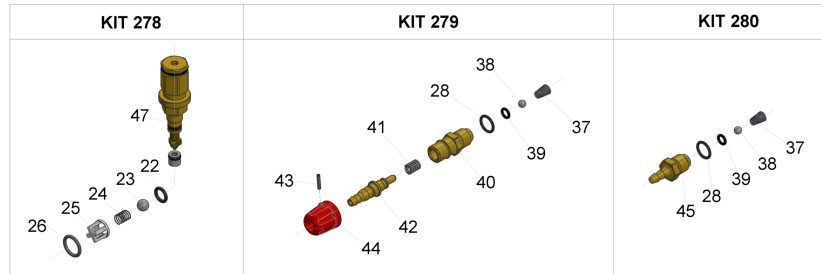

Testata con valvola integrata VH - Pump head with VH integrated valve

Ref.	Codice - Part n°	Qtà - Qty	Descrizione	Description
1	36350651	1	POMOLO DI REGOLAZIONE - ROSSO (S.53-58-59)	REGULATION KNOB - RED S. 53-58-59
2	10084666	1	FORCELLA POMOLO REGOLAZ. SERIE58	REGULATION KNOB YOKE
3	90384500	1	OR D. 18.72x2.62 NBR 70SH 3075	O-RING 18,72X2,6 (3075)
4	36348170	1	REGISTRO PRESSIONE (E2)	PRESSURE ADJUST SCREW
5	36348651	2	RONDELLA DI SCORRIMENTO SERIE58	SLIDE WASHER
6	94739500	1	MOLLA Dm 11.3x34.5 SERIE58	SPRING D.11,3x34,5
14	99126700	1	VITE M04X05 5929 A2-70	SCREW M4X5 UNI5929 S.S.
15	36347770	1	GHIERA DI MASSIMA PRESSIONE (E2)	MAX.PRESSURE NUT
17	90358700	1	OR D. 11.10x1.78 NBR 70SH 114	O-RING D. 11,11X1,78 (114)
18	90358100	1	OR D. 8.74x1.78 NBR 70SH 108	O-RING 8,73X1,78 - (108)
19	90503800	1	ANELLO ANTIEST. 9.0x12.0x1.5 SERIE58	ANTI-EXTR.RING D.9X12X1.5
20	90357800	1	OR D.7,66X1,78 (2031) - 70 SHORE	O-RING 7,66X1,78 (2031)
21	36348366	1	SEDE VALVOLA (E2)	REG. VALVE SEAT
22	90382300	1	OR D. 9.93x2.62 NBR 70SH 112	O-RING 9,92X2,62 (112)
23	97483800	1	SFERA 13/32"(10.319)G20 A420 (K7-HM)	BALL 13/32 (10,319)
24	94735500	1	MOLLA Dm 8.5x12.0 INOX	SPRING D. 8,5X12
25	36310451	1	GUIDA VALVOLA (E2)	VALVE GUIDE
26	90383900	1	OR D. 15.88x2.62 NBR 70SH 121	O-RING 15,88X2,62 (121)
27	36348970	1	NIPPLO D.3.0 G3/8"-F (E2)	NIPPLE D.3 G3/8F
27	36348870	1	NIPPLO D.3.0 M22x1.5-M (E2)	NIPPLE D.3 M22X1.5 M
27	36347970	1	NIPPLO D.3.0 G3/8"-M (E2)	NIPPLE D.3 G3/8M
27	36349070	1	NIPPLO D.3.0 NPT3/8-F (E2)	NIPPLE D.3 3/8NPT F
27	36348770	1	NIPPLO D.3.0 NPT3/8-M (E2)	NIPPLE D.3 3/8NPT M
28	90358500	1	OR D.10,82X1,78 (2043)	O-RING 10,82X1,78 (2043)
29	98204200	1	TAPPO G1/4x9 NICKEL	PLUG G1/4X9 NICKEL
30	90384100	1	OR D.17,13X2,62 (3068)	O-RING 17,12X2,62 (3068)
31	36318251	1	NIPPLO ASPIRAZIONE G 3/4 (W3)	INLET NIPPLE G 3/4
32	92892500	1	FILTRO D.12X35	FILTER D. 12X35
33	90382800	1	OR D. 12.37x2.62 NBR 70SH 3050	O-RING 12,37X2,62 (3050)
34	36256951	1	PORTAGOMMA ASPIRAZIONE PLAST. (W3)	INLET HOSE BARB FITTING (PL.)
35	92982800	1	GHIERA G 3/4 - Di.15 (W0)	WING NUT G3/4
36	10079866	1	UGELLO D.2,20 INIETT. ARANCIO SERIE58	INJECTOR NOZZLE D.2.20 ORANGE
36	10079566	1	UGELLO D.2,00 INIETT. BLU SERIE58	NOZZLE D. 2.00
37	94821700	1	MOLLA CONICA D. 4,3X7,3X11	TAPER SPRING D.4,3X7,3X11
38	97478200	1	SFERA 7/32" (5.556) G28 A420	BALL 7/32(5,556) STAINLESS
39	90357300	2	OR D. 5.28x1.78 NBR 70SH 2021	O-RING D. 5,28X1,78 (2021)

Testata con valvola integrata VH - Pump head with VH integrated valve

Ref.	Codice - Part n°	Qtà - Qty	Descrizione	Description
40	36348270	1	SEDE VALVOLA DETERGENTE (E2)	CHEM. HOSE BARB FITTING
41	94733400	1	MOLLA Dm.6.4x13 C.SET W3	SPRING D.6.4X12.5
42	36334270	1	OTTURATORE CON PORTAGOMMA C.SET W3	SHUTTER WITH HOSE FITTING
43	97661500	1	SPINA EL. 2.0x12 UNI6873 IP170	ELASTIC PIN D. 2X12
44	36348451	1	POMOLO DETERGENTE - ROSSO SERIE58	DETERGENT KNOB
45	36349270	1	PORTAGOMMA ASPIRAZIONE DETERGENTE (E2)	CHEM. HOSE BARB FITTING
46	59121941	1	TESTATA CON VALV. DX D.22 NICKEL (E3)	MANIFOLD D.22 W/VALVE*NICKEL P
47	36605401	1	GR. VALVOLA H POMPE (E2)	H REG. VALVE ASSY.
KIT278	34027801	1	KIT 278*VALVOLA INTEGRATA (58-59)	KIT 278 BUILT-IN VALVE 58-59
KIT279	34027901	1	KIT 279*CHIMJET REGOLABILE 58-59	KIT 279 ADJUSTABLE CHEM. INJ. 58-59
KIT280	34028001	1	KIT 280*CHIMJET FISSO (58-59)	KIT 280 FIXED CHEM.INJECTOR 58-59