

# 9. Explosionszeichnung / Exploded drawing

| Pos. Item No. | Gewinde Thread | Anzugsmoment Torque tension | Loctite od. gleichwert. Loctite or equivalent |
|---------------|----------------|-----------------------------|---|
| 7             | G1             | 12 Nm                       | Loc 5910                                      |
| 9             | M6             | 10 Nm                       |   |
| 11            | G1/4           | 30 Nm                       |   |
| 16            | M8             | 15 Nm                       |   |
| 20            | M6             | 12 Nm                       |   |
| 24B           | M8             | 22,5 Nm                     | Loc 243                                       |
| 41            | M30x1.5        | 70 Nm                       |   |
| 43            | G3/4           | 70 Nm                       | Loc 243                                       |
| 46            | M10            | 47,5 Nm                     |   |

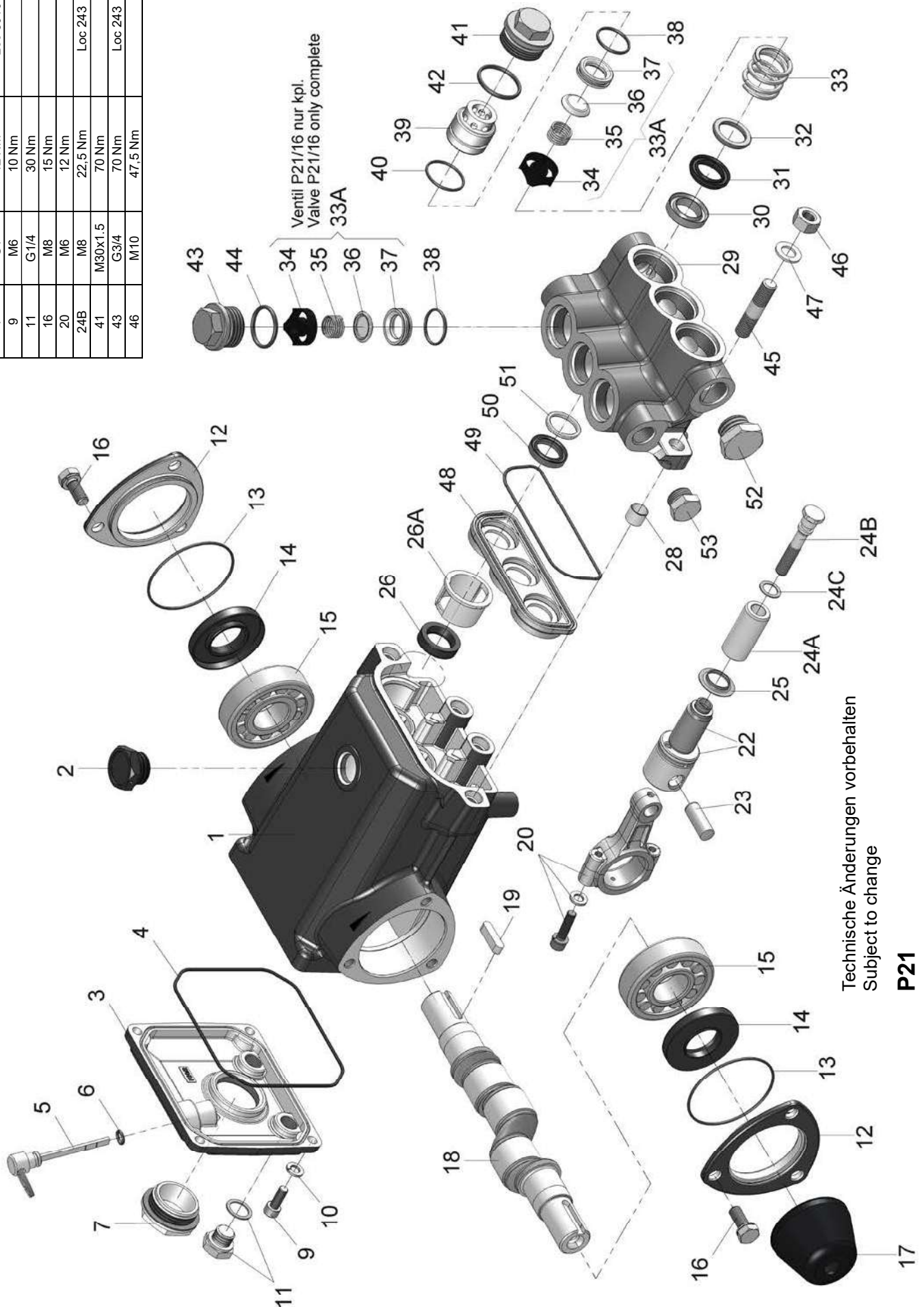

Technische Änderungen vorbehalten  
 Subject to change  
**P21**

## 10. Ersatzteilliste / Spare Parts List

| Lfd. Nr.<br>Item No. | Stückzahl<br>No. Off | Best.-Nr.<br>Code No. | Benennung                                    | Description                                    |
|----------------------|----------------------|-----------------------|--|--|
| 1                    | 1                    | 01.0258               | Antriebsgehäuse                              | Crankcase                                      |
| 2                    | 1                    | 00.2373               | Entl- Füllstopfen m. Dichtung G1/2           | Vent/Filler Plug w/Seal G1/2                   |
| 3                    | 1                    | 03.0154               | Getriebedeckel                               | Crankcase Cover                                |
| 4                    | 1                    | 06.0248               | O-Ring zu 3                                  | O-Ring for 3                                   |
| 5                    | 1                    | 00.0556               | Ölmeßstab                                    | Oil Dipstick                                   |
| 6                    | 1                    | 06.0053               | O-Ring zu 5                                  | O-Ring for 5                                   |
| 7                    | 1                    | 00.2416               | Ölschauglas kpl. G1                          | Oil Sight Glass Assy G1                        |
| 9                    | 4                    | 21.0069               | Zylinderkopfschraube m. Innensechskant       | Hexagon Socket Screw                           |
| 10                   | 4                    | 07.3052               | Federring                                    | Spring Ring                                    |
| 11                   | 2                    | 00.2372               | Ölablaßstopfen m. Dicht. G1/4                | Oil Drain Plug w/Seal G1/4                     |
| 12                   | 2                    | 03.0157               | Lagerdeckel                                  | Bearing Cover                                  |
| 13                   | 2                    | 06.0249               | O-Ring zu 12                                 | O-Ring for 12                                  |
| 14                   | 2                    | 06.0057               | Radialwellendichtring                        | Radial Shaft Seal                              |
| 15                   | 2                    | 05.0078               | Rillenkugellager                             | Grooved Ball Bearing                           |
| 16                   | 6                    | 21.0034               | Sechskantschraube                            | Hexagon Screw                                  |
| 17                   | 1                    | 07.4599               | Wellenschutz                                 | Shaft Protector                                |
| 18                   | 1                    | 11.0249               | Kurbelwelle P21/15, P21/18                   | Crankshaft P21/15, P21/18                      |
| 18                   | 1                    | 11.0267               | Kurbelwelle P21/16, P21/19, P21/23           | Crankshaft P21/16, P21/19, P21/23              |
| 19                   | 1                    | 07.5300               | Paßfeder                                     | Fitting Key                                    |
| 20                   | 3                    | 00.3287               | Gleitlagerpleuel kpl.                        | Connecting Rod Assy                            |
| 22                   | 3                    | 00.0597               | Kreuzkopf mit Plunger                        | Crosshead w/Plunger                            |
| 23                   | 3                    | 11.0066               | Kreuzkopfbolzen                              | Crosshead Pin                                  |
| 24A                  | 3                    | 11.0280               | Plungerrohr P21/16                           | Plunger Pipe P21/16                            |
| 24A                  | 3                    | 11.0115               | Plungerrohr P21/15, P21/19                   | Plunger Pipe P21/15, P21/19                    |
| 24A                  | 3                    | 11.0124               | Plungerrohr P21/18; P21/23                   | Plunger Pipe P21/18; P21/23                    |
| 24B                  | 3                    | 21.0351               | Spannschraube                                | Tension Screw                                  |
| 24C                  | 3                    | 06.0306               | Cu-Dichtring                                 | Copper Gasket                                  |
| 25                   | 3                    | 07.3918               | Ölabstreifer                                 | Oil Scraper                                    |
| 26                   | 3                    | 06.0064               | Radialwellendichtring                        | Radial Shaft Seal                              |
| 26A                  | 3                    | 07.2962               | Distanzhülse                                 | Spacer Sleeve                                  |
| 28                   | 2                    | 07.0558               | Zentrierhülse                                | Centring Sleeve                                |
| 29                   | 1                    | 01.0447               | Ventilgehäuse P21/16                         | Valve Casing P21/16                            |
| 29                   | 1                    | 01.0405               | Ventilgehäuse P21/15; P21/18; P21/19, P21/23 | Valve Casing P21/15; P21/18; P21/19, P21/23    |
| 30                   | 3                    | 07.1676               | Druckring P21/16                             | Pressure Ring P21/16                           |
| 30                   | 3                    | 07.0836               | Druckring P21/15, P21/19                     | Pressure Ring P21/15, P21/19                   |
| 30                   | 3                    | 07.0995               | Druckring P21/18; P21/23                     | Pressure Ring P21/18; P21/23                   |
| +31                  | 3                    | 06.0458               | Dachmanschette P21/16                        | V-Sleeve P21/16                                |
| *31                  | 3                    | 06.0283               | Dachmanschette P21/15, P21/19                | V-Sleeve P21/15, P21/19                        |
| o31                  | 3                    | 06.0308               | Dachmanschette P21/18; P21/23                | V-Sleeve P21/18; P21/23                        |
| 32                   | 3                    | 07.1675               | Manschettensstützring P21/16                 | Sleeve Support Ring P21/16                     |
| 32                   | 3                    | 07.0837               | Manschettensstützring P21/15, P21/19         | Sleeve Support Ring P21/15, P21/19             |
| 32                   | 3                    | 07.0903               | Manschettensstützring P21/18; P21/23         | Sleeve Support Ring P21/18; P21/23             |
| 33                   | 3                    | 07.2708               | Druckfeder P21/16                            | Pressure Spring P21/16                         |
| 33                   | 3                    | 07.0838               | Druckfeder P21/15; P21/18; P21/19, P21/23    | Pressure Spring P21/15; P21/18; P21/19, P21/23 |
| ++33A                | 6                    | 00.7286               | Ventil kpl. P21/16                           | Valve Assy. P21/16                             |
| **34                 | 6                    | 07.0956               | Federspannschale P21/15, /18, /19, /23       | Spring Tension Cap P21/15, /18, /19, /23       |
| **35                 | 6                    | 07.1941               | Ventilfeder P21/15, /18, /19, /23            | Valve Spring P21/15, /18, /19, /23             |
| **36                 | 6                    | 07.1004               | Ventilplatte P21/15, /18, /19, /23           | Valve Plate P21/15, /18, /19, /23              |
| **37                 | 6                    | 07.0292               | Ventilsitz P21/15, /18, /19, /23             | Valve Seat P21/15, /18, /19, /23               |
| ++38                 | 6                    | 06.0078               | O-Ring zu 33A P21/16                         | O-Ring for 33A P21/16                          |
| **38                 | 6                    | 06.0067               | O-Ring zu 37 P21/15; P21/18; P21/23          | O-Ring for 37 P21/15; P21/18; P21/23           |
| 39                   | 3                    | 07.1661               | Saugventilaufnahme P21/16                    | Suction Valve Adaptor P21/16                   |
| 39                   | 3                    | 07.0815               | Saugventilaufnahme P21/15, /18, /19, /23     | Suction Valve Adaptor P21/15, /18, /19, /23    |
| o++40                | 3                    | 06.0250               | O-Ring zu 39                                 | O-Ring for 39                                  |
| 41                   | 3                    | 07.1674               | Stopfen M30x1.5, P21/16                      | Plug M30x1.5, P21/16                           |
| 41                   | 3                    | 07.0814               | Stopfen M30x1.5, P21/15, /18, /19, /23       | Plug M30x1.5, P21/15, /18, /19, /23            |
| o++42                | 3                    | 06.0251               | O-Ring zu 41                                 | O-Ring for 41                                  |
| 43                   | 3                    | 07.1660               | Stopfen G 3/4, P21/16                        | Plug G 3/4, P21/16                             |
| 43                   | 3                    | 07.1514               | Stopfen G 3/4, P21/15, /18, /19, /23         | Plug G 3/4, P21/15, /18, /19, /23              |
| o++44                | 3                    | 06.0496               | O-Ring zu 43                                 | O-Ring for 43                                  |
| 45                   | 4                    | 21.0078               | Stiftschraube                                | Stud Bolt                                      |
| 46                   | 4                    | 07.2398               | Sechskantmutter                              | Hexagon Nut                                    |
| 47                   | 4                    | 07.2706               | Scheibe                                      | Disc   |
| 48                   | 1                    | 01.0451               | Zwischengehäuse P21/16                       | Intermediate Casing P21/16                     |
| 48                   | 1                    | 01.0439               | Zwischengehäuse P21/15, P21/19               | Intermediate Casing P21/15, P21/19             |
| 48                   | 1                    | 01.0440               | Zwischengehäuse P21/18, P21/23               | Intermediate Casing P21/18, P21/23             |
| o++49                | 1                    | 06.0252               | Form O-Ring zu 48                            | O-Ring for 48                                  |
| +50                  | 3                    | 06.0310               | Manschette P21/16,                           | Sleeve P21/16,                                 |
| *50                  | 3                    | 06.1298               | Nutring P21/15, P21/19                       | Seal Ring P21/15, P21/19                       |
| o50                  | 3                    | 06.1436               | Nutring P21/18, P21/23                       | Seal Ring P21/18; P21/23                       |
| 51                   | 3                    | 07.1020               | Manschettensstützring P21/16                 | Sleeve Support Ring P21/16                     |
| *51                  | 3                    | 07.3383               | Manschettensstützring P21/15, P21/19         | Sleeve Support Ring P21/15, P21/19             |
| o51                  | 3                    | 07.3384               | Manschettensstützring P21/18, P21/23         | Sleeve Support Ring P21/18, P21/23             |
| 52                   | 1                    | 07.0705               | Stopfen G1/2                                 | Plug G1/2                                      |
| 53                   | 1                    | 07.0608               | Stopfen G3/8                                 | Plug G3/8                                      |
|                      | 1                    | 00.1307               | Pumpenkopf kpl. P21/16 (29-44/52/53)         | Pump Head Assy P21/16 (29-44/52/53)            |
|                      | 1                    | 00.0788               | Pumpenkopf kpl. P21/15, P21/19 (29-44/52/53) | Pump Head Assy P21/15, P21/19 (29-44/52/53)    |
|                      | 1                    | 00.0789               | Pumpenkopf kpl. P21/18; P21/23 (29-44/52/53) | Pump Head Assy P21/18; P21/23 (29-44/52/53)    |
|                      | 1                    | 00.1965               | Antrieb kpl. P21/16 (1-28/45-47)             | Gear Assy P21/16 (1-28/45-47)                  |
|                      | 1                    | 00.1964               | Antrieb kpl. P21/15 (1-28/45-47)             | Gear Assy P21/15 (1-28/45-47)                  |
|                      | 1                    | 00.1966               | Antrieb kpl. P21/18 (1-28/45-47)             | Gear Assy P21/18 (1-28/45-47)                  |
|                      | 1                    | 00.6772               | Antrieb kpl. P21/19 (1-28/45-47)             | Gear Assy P21/19 (1-28/45-47)                  |
|                      | 1                    | 00.1967               | Antrieb kpl. P21/23 (1-28/45-47)             | Gear Assy P21/23 (1-28/45-47)                  |
| .                    | 1                    | 14.0498               | Rep. Satz Dichtungen P21/15, P21/19          | Seal Repair Kit P21/15, P21/19                 |
| +                    | 1                    | 14.0305               | Rep. Satz Dichtungen P21/16                  | Seal Repair Kit P21/16                         |
| o                    | 1                    | 14.0500               | Rep. Satz Dichtungen P21/18, P21/23          | Seal Repair Kit P21/18, P21/23                 |
| **                   | 1                    | 14.0496               | Rep. Satz Ventile P21/15, /18, /19, /23      | Valve Repair Kit P21/15, /18, /19, /23         |
| ++                   | 1                    | 14.0335               | Rep. Satz Ventile P21/16                     | Valve Repair Kit P21/16                        |

Bei Bestellung von Ersatzteilen bitte Bestell-Nr., Pumpen-Nr. und -type angeben  
When ordering please state Code No., Pump Model and Pump Serial No.