

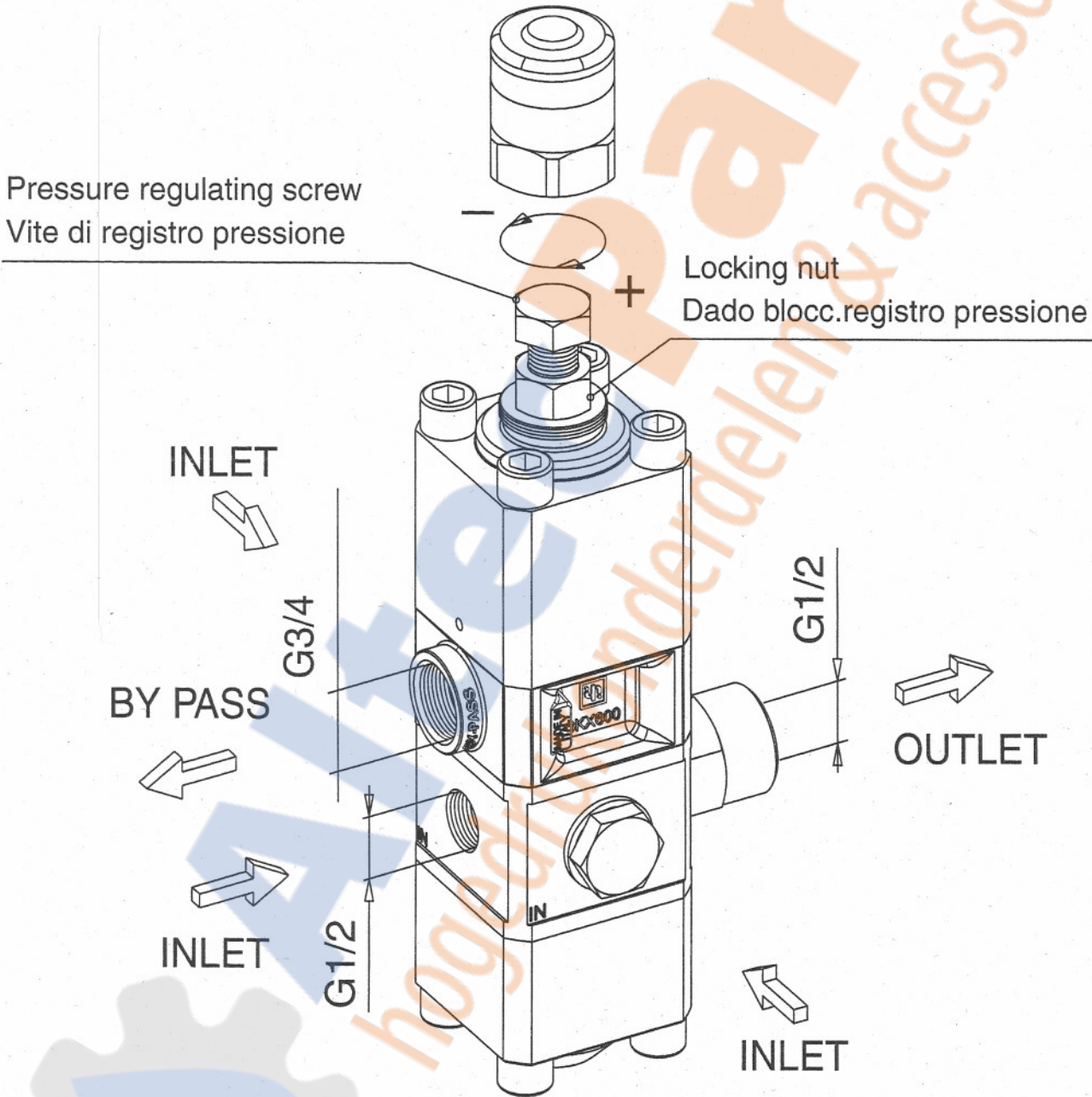

≡ B K X 6 0 0 ≡



AUTOMATIC PRESS. REGULATOR • REG. AUTOM. DI PRESSIONE



DIS. COD. 36.9011.00

TECHNICAL CHARACTERISTICS - CARATTERISTICHE TECNICHE

VOLUME PORTATA		MAX. PRESS.			WEIGHT PESO	
l/min.	G.P.M. (USA)	bar	Mpa	p.s.i.	kg	lbs
60	15.85	600	60	8700	7.74	17.03

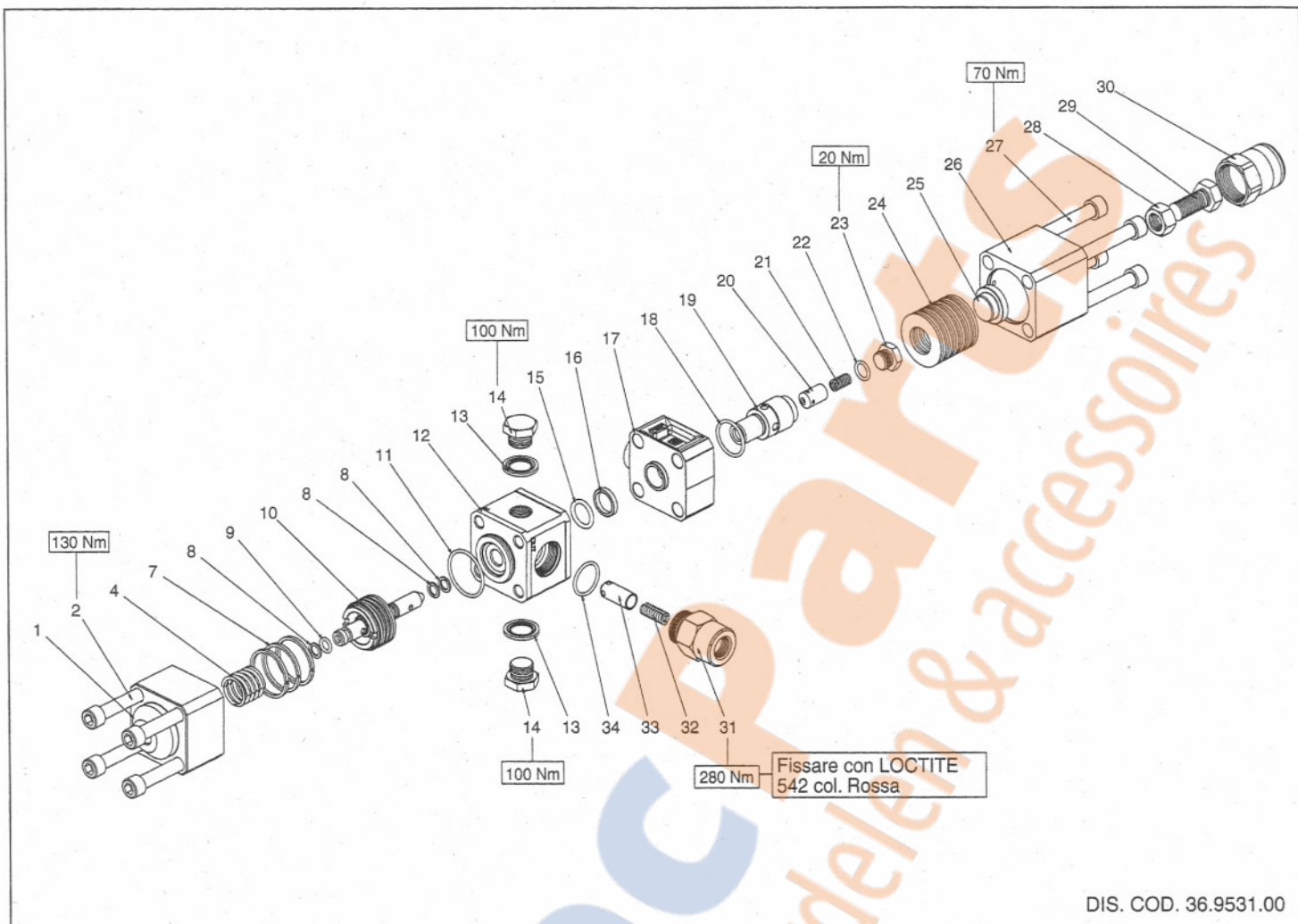

DIS. COD. 36.9531.00

POS.	CODE CODICE	DESCRIPTION DESCRIZIONE	N. PCS.	POS.	CODE CODICE	DESCRIPTION DESCRIZIONE	N. PCS.
1	36.3120.66	Corpo valvola inferiore	1	20	36.3359.66	Valvola	1
2	99.4387.00	Vite M12x70 UNI 5931	4	21	94.7358.00	Molla Ø8.5x22	1
4	94.7572.00	Molla Ø26.2x28.5	1	22	90.3830.00	OR Ø13.1x2.62 (117)	1
7	92.7776.00	Fascia elastica per camicia Ø45	3	23	98.2101.00	Tappo G3/8"x9.5	1
8	90.5052.00	Anello antiest. Ø9.5x14x1.5	3	24	94.8585.00	Molla a tazza 50x25.4x3	12
9	90.3819.00	OR Ø9.13x2.62 (109)	1	25	36.3127.66	Piattello molla	1
10	36.7111.01	Assieme asta e pistoncino	1	26	36.3123.66	Corpo valvola superiore	1
11	90.3877.00	OR Ø39.34x2.62 (3156)	1	27	99.4450.00	Vite M12x1.75x120 UNI 5931	4
12	36.3121.66	Corpo valvola	1	28	92.2565.00	Dado M16x1.5	1
13	93.1972.00	Rondella con tenuta G1/2"	2	29	99.5136.00	Vite M16x1.5x41	1
14	98.2181.00	Tappo G1/2"x13	2	30	36.3132.70	Tappo	1
15	90.4041.00	OR Ø20.22x3.53 (4081)	1	31	95.2730.00	Niplo di riduzione M e F M30x1.5xG1/2"	1
16	90.5132.00	Anello antiest. Ø20x26x4	1	32	94.7365.00	Molla Ø8.8x31	1
17	36.3122.41	Corpo valvola intermedio	1	33	36.3125.66	Ugello	1
18	90.3865.00	OR Ø29.82x2.62 (3118)	1	34	90.3861.00	OR Ø26.65x2.62 (3106)	1
19	36.3358.66	Sede valvola	1				



INTERPUMP GROUP

VIA E. FERMI, 25 - 42049 S. ILARIO - REGGIO EMILIA (ITALY)
 TEL. +39 - 0522 - 904311 - TELEFAX + 39 - 0522 - 904444
 E-mail: info@interpumpgroup.it - http://www.interpumpgroup.it